



GERAND ENGINEERING -

9431 SCIENCE CENTER DRIVE, NEW HOPE MN 55428
952.374.1320 WWW.GERAND.COM

FIRE PUMP TEST METER G-250-4

CONSTRUCTION & SPECIFICATIONS

VENTURI: ZINC PLATED STEEL

VALVES: ONE PIECE BRASS BODY
ZINC DIECAST STEEL HANDLE

HOSES: 3/16" NYTRILE CORE, POLYESTER
BRAID AND EPDM SYNTHETIC COVER

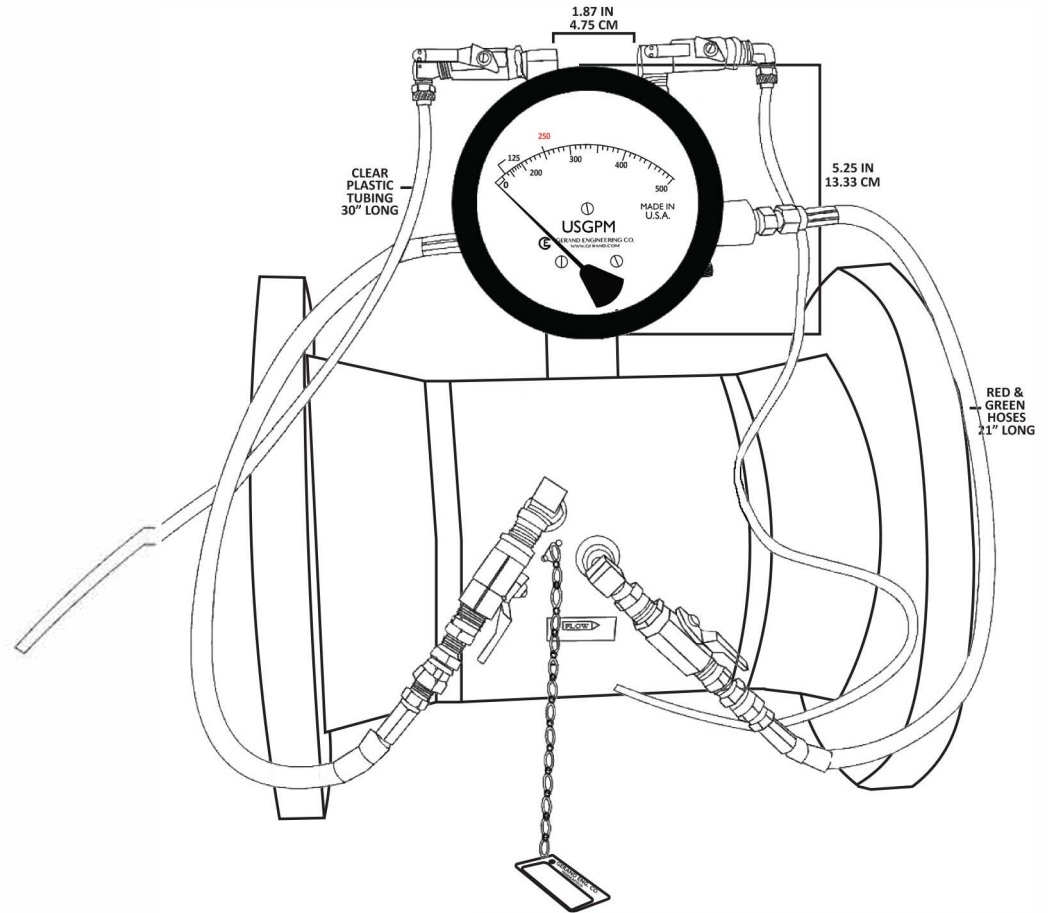

METER DATA

CONSTRUCTION: ALUMINUM BODY

OPERATION: BUNA "N" DIAPHRAGM

ACCURACY: $\pm 2.0\%$

TEMPERATURE: 200° F MAX

PRESSURE: 1500 PSI MAX

APPROX. WEIGHT: 3 LBS/EACH

4 1/2" DIAL STANDARD - 6" AVAILABLE

WELD-NECK FLANGES
RAISED FACE

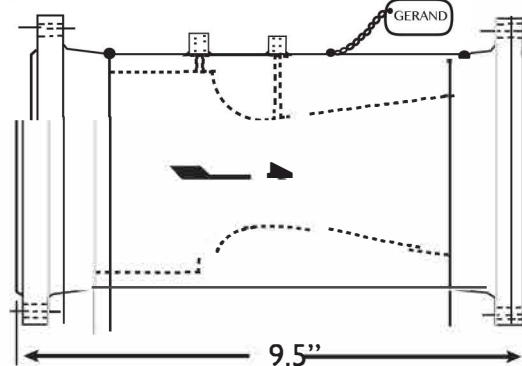

WEIGHTS & DIMENSIONS

WEIGHT: 51 LBS

SHIPPING DIMENSIONS: 13" x 13" x 21" BOX